

# Tsurumai & Daiko Campus Multi-Purpose Restroom Map June 2021

- :Bldg. with multi-purpose restroom
- :Floor Number with multi-purpose restroom

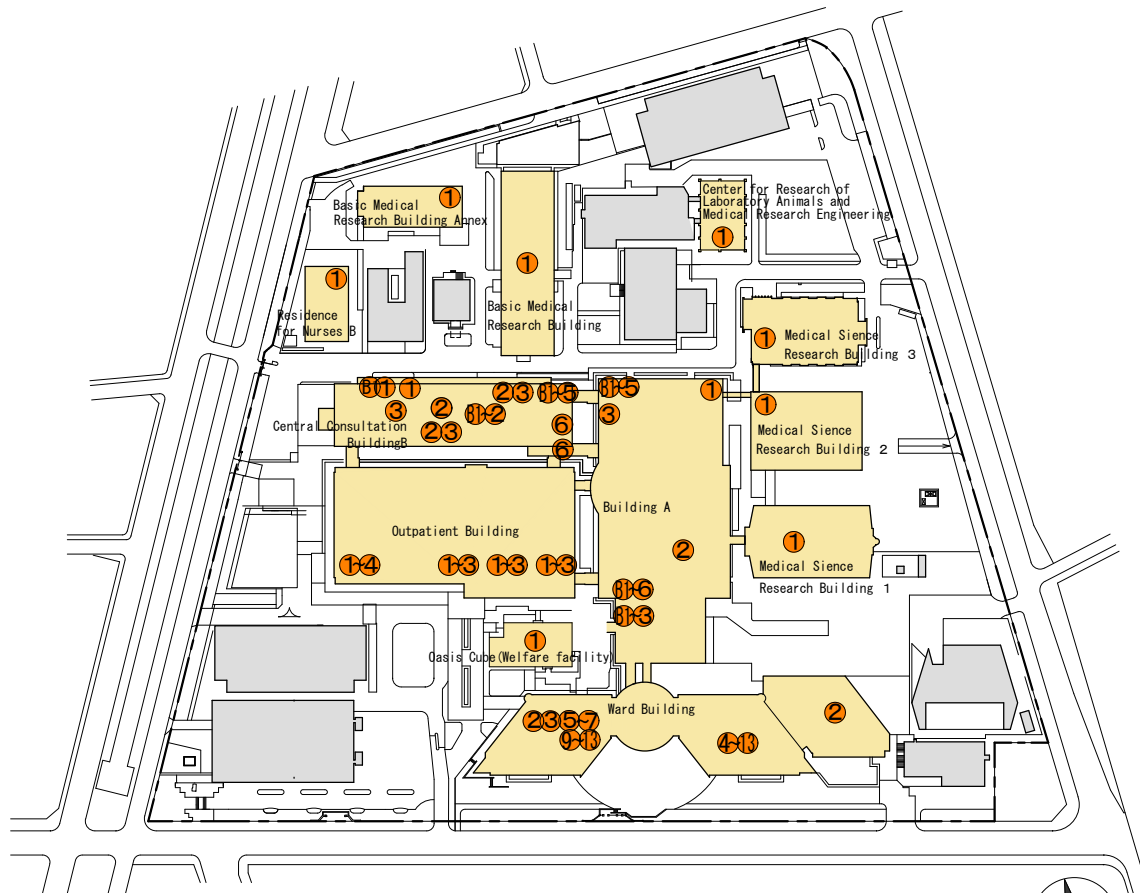

Tsurumai Campus

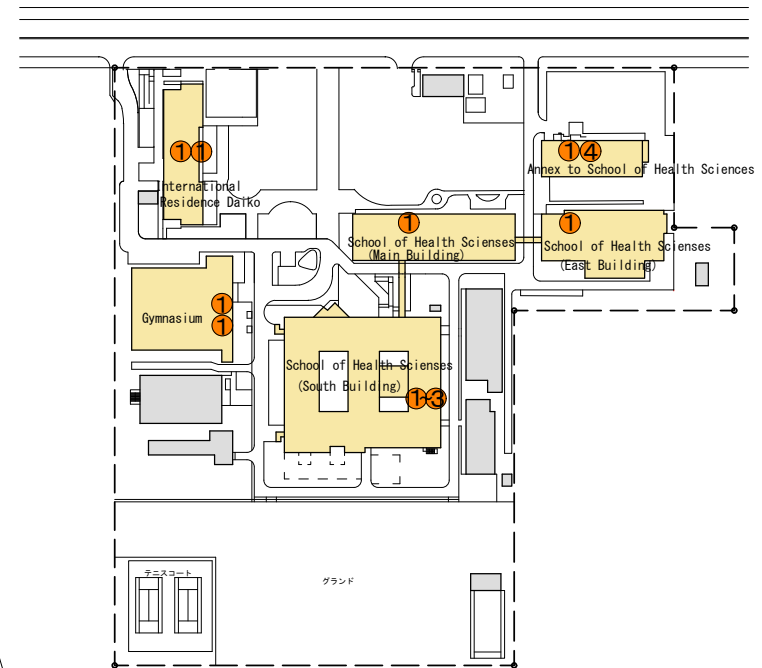

Daiko Campus



Tsurumi Campus Multi-Purpose Restroom Facilities (as of June 2021)

School etc. Name	Bldg. No.	Building Name	Location	Function / Facility								Size (Interior Dimensions)	Note
				Ostomate friendly	Child Seat	Diaper Changing Table	Multipurpose Seat	Changing Board	Emergency Call Button	Flushing Sound Device			
Graduate School of Medicine / School of Medicine	001	Basic Medical Research Building	1F	×	×	×	×	○	○	○	2140*1900		
	003	Basic Medical Research Building Annex	1F	×	×	×	×	○	○	×	2080*1920		
	075	Center for Research of Laboratory Animals and Medical Research Engineering	1F	○	×	×	×	○	○	○	1850*2600		
	079	Residence for Nurses B	1F Nursery	×	×	×	×	×	○	×	2035*1980	with a Toilet for Children	
	100	Ward Building	2F East Side	×	×	×	×	×	×	○	×	2440*2110	
			2F West Side	×	×	×	×	×	×	○	×	2015*3120	
			3F East Side	×	×	×	×	×	×	○	×	1860*2055	
			4F West Side	×	×	×	×	×	×	○	×	1815*2110	
			5F East Side	×	×	×	×	×	×	○	×	1905*2190	
			5F West Side	×	○	×	×	×	×	○	×	1870*2110	
			6F East Side	×	×	×	×	×	×	○	×	1840*1990	
			6F West Side	○	×	×	×	×	×	○	×	1870*2105	
			7F East Side	×	×	×	×	×	×	○	×	1835*1990	
			7F West Side	○	×	×	×	×	×	○	×	1865*1855	
			8F West Side	×	×	×	×	×	×	○	×	1865*2110	
			9F East Side	×	×	×	×	×	×	○	×	1835*1990	
			9F West Side	×	×	×	×	×	×	○	×	1420*2110	
			10F East Side	×	×	×	×	×	×	○	×	1835*1990	
			10F West Side	×	×	×	×	×	×	○	×	1865*2110	
			11F East Side	×	×	×	×	×	×	○	×	1855*2015	
			11F West Side	×	×	×	×	×	×	○	×	1870*2110	
	12F East Side	×	×	×	×	×	×	○	×	1840*2020			
	12F West Side	×	×	×	×	×	×	○	×	1870*2110			
	13F East Side	×	×	×	×	×	×	○	×	2020*1845			
	13F West Side	×	×	×	×	×	×	○	×	1865*2100			
	University Hospital	105	Central Consultation Building A	B1F (B1A08)	○	○	○	○	×	○	○	2780*1760	
				B1F (B1A09)	×	×	×	×	×	○	○	2040*1765	
				B1F (B1A14)	×	○	×	×	×	○	○	2055*1955	
				1F (1A12)	○	○	○	×	×	○	○	2785*1760	
				1F (1A13)	×	×	×	×	×	○	○	2040*1765	
				1F (1A17)	×	○	×	×	×	○	○	2030*1950	
				1F (1A19)	×	○	×	×	×	○	○	2035*1950	
				2F (2A09)	○	○	○	○	×	○	○	2860*1765	
				2F (2A10)	×	×	×	×	×	○	○	2040*1765	
				2F (2A14)	×	○	×	×	×	○	○	2035*1945	
				2F (2A06)	×	○	○	×	×	○	○	2010*2435	
				3F (3A03)	○	○	○	○	×	○	○	2860*1765	
				3F (3A04)	×	×	×	×	×	○	○	2040*1765	
				3F (3A06)	○	○	○	○	×	○	○	2905*1705	
				3F (3A05)	×	×	×	×	×	○	○	2090*1705	
				4F (4A07)	×	×	○	×	×	○	○	2070*1950	
				4F (4A10)	×	○	×	×	×	○	○	2035*1950	
				5F (5A08)	×	×	○	×	×	○	○	2075*1950	
				5F (5A11)	×	○	×	×	×	○	○	2035*1950	
				6F (6A06)	×	×	○	×	×	○	○	2075*1950	
	106	Outpatient Building	1F (01A09)	○	○	○	○	×	○	×	2040*3455		
			1F (01A02)	×	×	○	○	×	○	×	2055*2610		
1F (01A03)			○	○	○	○	×	○	×	1865*4405			
1F (01A04)			×	×	○	○	×	○	×	2010*2610			
2F (02A10)			×	×	○	×	×	○	×	2055*1980	with a Toilet for Children		
2F (02A02)			×	×	○	○	×	○	×	2015*2785			
2F (02A03)			○	○	○	○	×	○	×	1905*4400			
2F (02A04)			×	×	○	○	×	○	×	2010*2785			
3F (03A13)			×	×	○	×	×	○	×	2050*1980	with a Toilet for Children		
3F (03A02)			×	×	○	○	×	○	×	2015*2795			
3F (03A03)			○	○	○	○	×	○	×	1910*4405			
3F (03A04)			×	×	○	○	×	○	×	2010*2785			
4F (04A04)			×	×	○	×	×	○	×	2050*1980	with a Toilet for Children		

Tsurumi Campus Multi-Purpose Restroom Facilities (as of June 2021)

School etc. Name	Bldg. No.	Building Name	Location	Function / Facility								Note
				Ostomate friendly	Child Seat	Diaper Changing Table	Multipurpose Seat	Changing Board	Emergency Call Button	Flushing Sound Device	Size (Interior Dimensions)	
Graduate School of Medicine / School of Medicine University Hospital	107	Central Consultation BuildingB	B1F (B1A02)	○	○	○	×	×	○	○	1855*1935	
			B1F (B1A03)	×	×	×	×	×	○	○	2785*1830	
			B1F (B1A04)	×	×	×	×	×	○	○	2760*1715	
			1F (01A02)	○	○	○	×	×	○	○	1830*1910	
			1F (01A03)	○	×	×	×	×	○	○	2460*1830	
			1F (01A04)	○	○	○	×	×	○	○	2080*2295	
			1F (01A05)	○	×	×	×	×	○	○	2060*2310	
			2F (02A03)	○	○	○	×	×	○	○	1735*2150	
			2F (02A04)	○	○	○	×	×	○	○	1735*2155	
			2F (02A05)	×	×	×	×	×	○	○	1930*1785	
			2F (02A09)	×	×	×	×	×	○	○	2085*1780	
			2F (02A10)	×	×	○	○	×	○	○	2185*2185	
			3F (03A03)	○	○	○	×	×	○	○	1740*2155	
			3F (03A04)	○	○	○	×	×	○	○	1735*2160	
			3F (03A05)	○	×	×	×	×	○	○	1765*2185	
			3F (03A06)	○	×	×	×	×	○	○	2100*1765	
			4F (04A02)	○	○	○	×	×	○	○	1835*1865	
			5F (05A01)	○	○	○	×	×	○	○	1825*2375	
			6F (06A01)	×	×	×	×	×	○	○	2030*1985	for Men
	6F (06A02)	×	×	×	×	×	○	○	2120*1985	for Women		
110	Medical Science Research Building 1	1F	×	×	×	×	○	○	×	1850*2500		
111	Medical Science Research Building 2	1F	○	×	×	×	○	○	×	1980*2065		
112	Medical Science Research Building 3	1F	○	○	○	×	○	○	×	2005*1855		
-	Oasis Cube(Welfare facility)	1F	○	×	○	×	×	○	○	2530*1920		

Daiko Campus Multi-Purpose Restroom Facilities (as of June 2021)

School etc. Name	Bldg. No.	Building Name	Location	Function / Facility								Note
				Ostomate friendly	Child Seat	Diaper Changing Table	Multipurpose Seat	Changing Board	Emergency Call Button	Flushing Sound Device	Size (Interior Dimensions)	
School of Health Sciences	012	School of Health Sciences (South Building)	1F	×	×	×	×	○	○	○	1750*2000	
			2F	×	×	×	×	○	○	○	2000*2200	
			3F	×	×	×	×	○	○	○	2000*2200	
	027	School of Health Sciences (Main Building)	1F	×	○	○	×	○	○	×	1800*2300	
	009	Gymnasium	1F Men's changing room	×	×	×	×	×	○	×	1800*2200	
			1F Women's changing room	×	×	×	×	×	○	×	1800*2200	
	023	Annex to School of Health Sciences	1F	○	×	×	×	○	○	○	1900*2100	
			4F	○	×	×	×	○	○	○	1900*2100	
	026	School of Health Sciences (East Building)	1F	×	×	×	×	○	○	×	2250*2150	
	029	International Residence Daiko	1F (1) South Side	○	○	×	×	○	○	×	2250*1970	
1F (2) North Side			×	×	○	×	○	○	×	2250*1970		